

INTELLIGENT VIDEO CONFERENCING

Combining technologies to make video conferencing more engaging

The Audio Tracking solution from Canon utilises selected Canon PTZ cameras with Canon's own proprietary software and Sennheiser's TeamConnect Ceiling 2 (TCC2) microphone.

Sennheiser TCC2 detects direction of a person's voice, then Canon's Audio Tracking Software will execute a pre-set position of the PTZ camera corresponding to the audio source direction.

The end-result is that productions can take place without a camera operator, instead the ceiling microphone will detect who is speaking and ensure that person is appropriately framed.



Canon's Audio Tracking Software

Flexible calibration

Enjoy easy calibration of Canon PTZ cameras and Sennheiser microphone to ensure it matches your room environment. Areas can be selected so when audio is detected in a certain zone, the camera moves to that position.

Priority pre-set zones ensure the perfect shot

Select priority pre-set zones meaning if someone is speaking within a priority zone, the camera will move to that area even if audio is detected elsewhere.

Move to default position when the room become silent

If no audio is detected in the room, then the software will move to the default position of PTZ camera. Considering a meeting room, it will show entire room when the room become silent.

Tracking configuration settings

Tracking Delay and Speed

This setting enables users to delay the PTZ movements so the camera doesn't move too quickly when it detects another voice in the room ensuring all voices are heard accurately. Users can also set the PTZ camera's moving speed to dictate how quick the PTZ movements are.

Microphone Sensitivity Threshold

Adjust the threshold level for audio detection which would trigger camera movements, this enables the system to be tailored to different types of environments; both noisy and quiet.

Example of system set-up

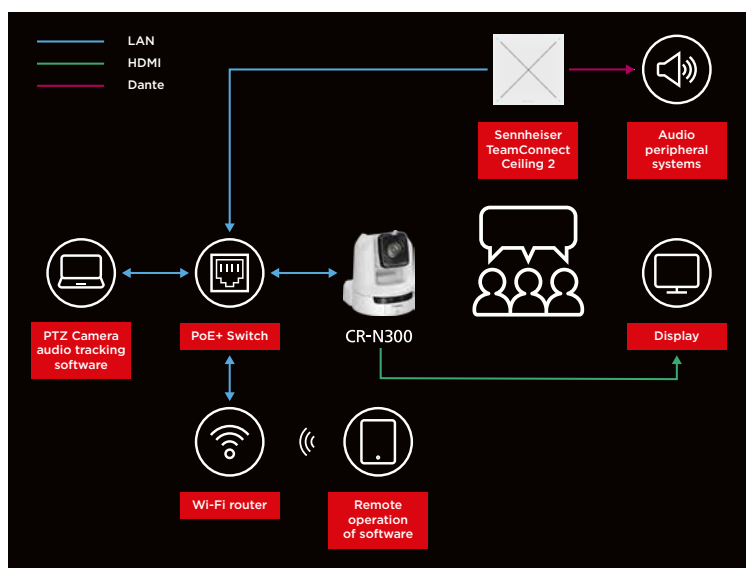

Use cases



Corporate meetings

Create powerful automated meetings without a generic wide angle shot.



Education

Let your students engage in lessons more without worrying about a camera operator.



Corporate Seminars

Make events special and interactive by capturing not only the speaker, but the audience.

Benefits of Canon's Audio Tracking system



No camera operator

Due to the autonomous nature of this system, camera operators are no longer required for productions as the software can easily detect the speaker quickly and accurately.



Quick and accurate focussing

Canon PTZ cameras are equipped with Hybrid Auto Focus or Dual Pixel Auto Focus systems meaning that when the next subject is detected, the focus is sharp and fast.



4K image quality

All of Canon PTZ cameras have 4K UHD resolution meaning whatever the production, they can be streamed or recorded in stunning image quality.



Sennheiser integration

Sennheiser's TCC2 ceiling microphone is a popular industry solution for microphones across multiple sectors, this compatibility makes it easy to integrate into new or existing infrastructures.



Smooth and precise control

Canon PTZ cameras are equipped with an advanced drive mechanism that enables both slow and precise movements, but also fast and precise movements making it a true workhorse for this solution.

Applicable cameras



CR-N700

- 1.0 Type Sensor & DIGIC DV7 Processor
- 15x Optical Zoom (30x Advanced in Full HD)
- Dual Pixel CMOS AF with EOS iTR AF X
- HDMI, 12G-SDI, 3G-SDI, Time Code, GEN-LOCK PoE++, 3.5mm mic and Dual XLR connections



CR-N500

- 1.0 Type Sensor & DIGIC DV6 Processor
- 15x Optical Zoom
- Dual Pixel CMOS AF
- HDMI, 3G-SDI, PoE+, 3.5mm mic and Dual XLR connections



CR-N300

- 1/2.3 Type Sensor & DIGIC DV6 Processor
- 15x Optical Zoom
- Hybrid AF
- HDMI, 3G-SDI, PoE+, USB-C and 3.5mm mic

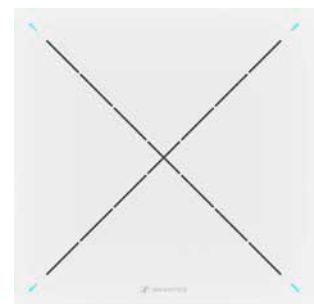

Sennheiser ceiling microphone

The TeamConnect Ceiling 2, with its patented automatic dynamic beamforming technology, was already a leader in conference room audio technology. Now, with the addition of TruVoicelift and advanced zone control, TeamConnect Ceiling 2 combines the advantages of a boundary microphone and a microphone array.

TeamConnect Ceiling 2 offers customers unparalleled levels of control with the addition of a priority zone (allowing a single area in the room to be highlighted), 5 advanced exclusion zones (for pinpoint targeting and removal of unwanted noise sources) and more.