



output
Professional audio, video & lighting



INSTALL SOUND SOLUTIONS



We, the team of RCF Netherlands are part of dBTechnologies Deutschland GmbH with headquarters in Cologne have the claim to always achieve the best possible result for our customers and their projects. This is our incentive and this drives us every day anew.

We make your request our business! We take the time to understand your project and the general conditions and address your individual situation. We develop ideas and solutions to find the best possible result for you. Together with our network of partners in your region, we implement the project on time and on budget, always remaining the right contact for you.

As part of the RCF Group, we have access to a product portfolio that is unique in the market. Every day, teams of engineers, acousticians and mechanical specialists work on new ideas and technical innovations. The very high vertical range of manufacture of our parent company in Italy makes it possible to always find individual and attractive solutions for our projects.

Benefit from further services of our brands: after delivery, installation and commissioning, we are at your side with advice and support - whether e.g. technical training of your employees, maintenance or even emergency support, we are always there for you.

About Us	02
Shop	06
Bar / Restaurant	08
Worship	12
Culture / Conference	16
Educational	20
Stadia	24
Contact	30



TECHNOLOGY & DEVELOPMENT

Over 70 years of experience in the development and production of loudspeakers and their components enable RCF to offer you an enormous range of solutions. In addition to passive loudspeaker solutions, RCF users have access to state-of-the-art active loudspeaker systems that can be remotely controlled and monitored at any time thanks to the intelligent RD-Net software.

Thanks to the R&D department staffed with experienced specialists, RCF offers its customers the possibility to obtain all key technologies from our company. From the individual transducer, electronics and software to the finished loudspeaker, at RCF everything comes from one source!

Our own production, wood manufacturing, as well as a versatile plastic processing set no limits to new solutions in terms of material and processing.

Due to this depth of development and production, all solutions from RCF are well thought out down to the last detail and are specially designed for the respective required application purposes.

More than 700 employees worldwide ensure that every user in the world of RCF sees himself not just as a customer, but as part of the family. Solutions, competence and customer proximity, that's what RCF stands for as one of the largest manufacturers of loudspeaker systems in Europe!





TECHNICAL PLANNING & SIMULATION

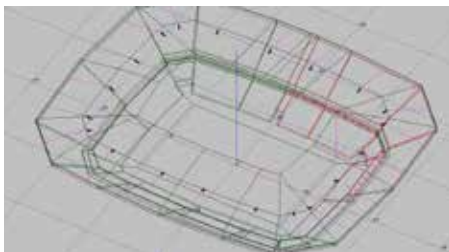

Extensive planning is crucial for the quality of a complex sound reinforcement system.

Our team supports you from the selection of the right components to three-dimensional simulations. Benefit from our many years of experience with projects of any size.

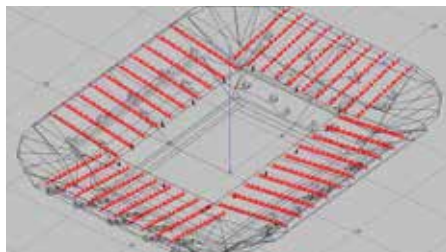

The RCF Engineering Support Group (ESG) is a department specialized in installation planning, located at the headquarters in Italy, which provides support in project planning. Through direct cooperation with all departments and trades involved in production, solutions are successfully developed and implemented that were often previously unthinkable.





ZARA

The aesthetic requirements of the store were also applied to the design of the background sound system in the store area and the implementation of the voice alarm system, which was successfully implemented.

- MQ 50A
- DXT 7000

COLOGNE

MQ 50

COMPACT 2-WAY LOUDSPEAKER

The MQ50P is a compact full-range loudspeaker with a swivel and tilt wall mounting system. Its high power and extended frequency response allows for good music and speech reinforcement as a background or even main system. It has a 5" bass and a horn-loaded dome tweeter with a dispersion of 120° horizontally and 100° vertically. The MQ50 is available in white and black.

- 2-Way Bass Reflex Loudspeaker
- 5" woofer, 0.75" tweeter with waveguide
- crossover frequency: 4500 Hz, 12/12 dB/oct
- music/rated power: 120/60 watts
- impedance: [bypass] 16 Ω
- Housing made of high density polystyrol
- Connections: removable Euroblock



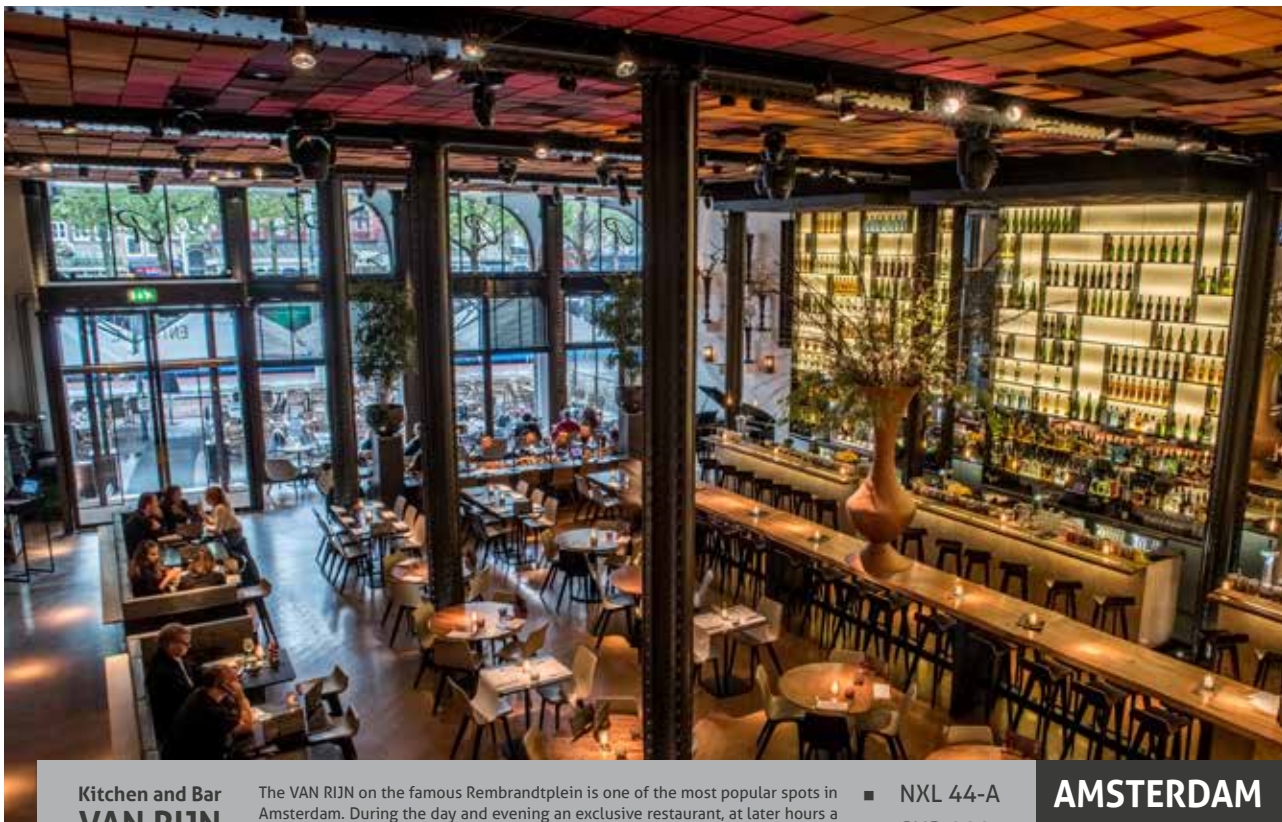

Kitchen and Bar
VAN RIJN

The VAN RIJN on the famous Rembrandtplein is one of the most popular spots in Amsterdam. During the day and evening an exclusive restaurant, at later hours a bar and club where well-known DJs fill the room with danceable sound.

- NXL 44-A
- SUB 9003

AMSTERDAM

NXL 44-A

ACTIVE 2-WAY COLUMN SYSTEM

With the NXL 44-A, RCF has developed a unique and powerful 2-way line source equipped with three 10-inch neodymium woofers and a 1.4-inch driver with 3-inch voice coil on an asymmetrical waveguide. Perfect tuning of all speakers ensures extremely uniform coverage with extended frequency response. Precisely controlled by the integrated DSP and driven by a 2-channel digital power amplifier, the NXL 44-A offers an extremely natural sound image and high sound pressure. The asymmetrical horn design ensures very precise dispersion and avoids unwanted reflections.

- Digital 2-channel power amplifier with 1400Watt output power
- 90° x 30° coverage (+5°, -25°)
- 3 X 10" neodymium woofer
- 1.4" neodymium compression driver, 3" voice coil
- Digital signal processing
- 3 X 10" neodymium woofers



BAR / RESTAURANT

LOUI LOUI

Modern Bar, Restaurant and Kitchen. The open architecture is divided into different zones, bar area, tables and outdoor area, which are played differently depending on the time of day, provide the appropriate atmosphere.

- COMPACT M05
- MQ50C
- BM9804



CANNIBALE ROYALE

The Cannibale Royale is famous for its welcoming and also bustling atmosphere, coupled with famously very good food. Fittingly, the RCF Compact M speakers used deliver a pleasant and assertive sound.

- COMPACT M08
- IPS 2700



COMPACT M

The Compact M series comprises a family of 2-way full-range universal loudspeakers with many application possibilities. With their pleasant sound, they offer the best speech intelligibility, especially at close range.

The Compact M loudspeakers all deliver a high characteristic sound pressure level, typical for professional speakers with generously dimensioned magnets in commercial applications. Compression drivers with Wave Guide ensure hi-fi sound with a uniformly wide frequency response. The elegant and compact design with clean paint finish, for example, allows the Compact M 08 to fit seamlessly into almost any environment, even under demanding conditions. Optional accessories allow for recessed wall or ceiling mounting.



IZAKAYA

Modern Bar, Restaurant and Kitchen. The open architecture is divided into different zones, bar area, tables and outdoor area, which are played differently depending on the time of day, provide the appropriate atmosphere.

- COMPACT M

THE BULLDOG

The Bulldog is located on Amsterdam's most popular square and entertainment in Amsterdam, the Leidseplein. It invites its guests to enjoy Amsterdam and Relax. Either in the in-house coffee shop, or at the bar with stage on which impressive performances are shown every night.

- TTL4
- TTS18



TT+

TT+ High Definition Touring and Theatre is the flagship RCF solution for first class performing arts, sport events, speech reinforcement, live concerts, and high-end fixed installations.

Low weight and easy set-up, robust and reliable hardware and flying equipment, remote monitoring and management via RDNet. The TT+ range consists of true active and passive models for point source, vertical and horizontal deployment with a top of the class sound performance and maximum scalability.



BAR / RESTAURANT



ECB GEMEINDE

In an acoustically demanding environment, two linear arrays of 9 HDL 10-A units each provide a high-quality sound reinforcement result that guarantees maximum speech intelligibility. For the reproduction of music, the system is temporarily supplemented by mobile subwoofers SUB 9003-AS.

- HDL10-A
- SUB 9003

PADERBORN

HDL 10-A

ACTIVE LINE ARRAY MODULE

HDL-10-A is an active, 2x8" line array system. The extremely compact dimensions, powerful transducers and unique composite enclosure design make the HDL 10-A the ideal sound reinforcement tool.

Each module is driven by a 2-channel digital power amplifier with 1400 watts peak power and features a powerful DSP for signal processing.

- 1400 watts peak power - 700 watts continuous power (RMS)
- 133 dB maximum sound pressure level
- Frequency response 65 Hz - 20 kHz
- 2 x 8-inch woofers
- 1 x 2-inch compression driver
- DSP-controlled input section with selectable presets
- Flight and installation hardware available
- Wood-reinforced polypropylene enclosure
- Also available in black



Digitally controllable line array loudspeakers guarantee maximum speech intelligibility in the acoustics typical of traditional churches with long reverberation times.

with long reverberation times typical of traditional churches, and can often reduce installation costs, as the long range of such systems means that delay loudspeakers are often not required.

Delay loudspeakers can be dispensed with.

SANKT JOSEPH

- VSA

EV Kirche Solingen

- VSA



VSA 850 / 125 / 2050 II

Highly advanced column loudspeaker with fixed or electronically controllable vertical directivity. Suitable for acoustically critical applications or rooms with architectural limitations.

The VSA II column loudspeakers are capable of precisely directing audio signals to an audience area. Thanks to state-of-the-art digital signal processing, vertical dispersion can be controlled to direct sound like a "beam" to the desired areas, significantly reducing the acoustic anomalies of highly reverberant rooms. Device control is via RCF's proprietary RDNet software and also offers useful voice alert features. The result is improved transparency with significantly increased speech intelligibility.



WORSHIP



HAUS LEIPZIG

Haus Leipzig is a venue for music, culture, club concerts, conferences and gala events with a capacity of up to 1500 visitors. In order to meet these requirements, a linear array system with two lines of 10 each HDL 30-A, supported in the bass range by SUB 9004-AS subwoofers.

- HDL30-A
- SUB 9004

LEIPZIG

HDL 30-A

ACTIVE 2-WAY LINE ARRAY MODULE

The RCF HDL 30-A is a compact, active 2-way line array system with 2-channel amplifier, equipped with two 10-inch woofers and an impressive 4-inch titanium cone compression driver. The time coherent coherent waveguide is the result of intensive research and development.

and development. The HDL 30-A is the first line array module in a composite enclosure with 0 degrees of phase and an extremely linear amplitude response. The integrated Class-D amplifier with 2200 watts, as well as state-of-the-art RCF transducers with neodymium magnets provide excellent fidelity and up to 137 dB maximum sound pressure. The HDL 38-AS bass module for flown applications is the ideal complement to the HDL 30-A line array.

- 2-channel Class D amplifier, 2200 watts
- 137 dB maximum sound pressure level
- 1.4 inch titanium cone compression driver with 4.0 inch voice coil
- 2 x 10 inch neodymium woofers with 2.5 inch voice coil
- Exclusive FIRPHASE technology
- RNet for control and management



STADTHALLE OSTERODE

Small but fine town hall in the Harz region with a capacity of up to 800 guests. The sound is provided by two linear arrays, each with 6 HDL 26-A units, as well as various TT 052-A delay and fill loudspeakers. The audio signals are distributed via the DX 1616 digital controller.

- HDL26-A
- TT 052-A
- DX 1616



MONFORTHHAUS

The large hall of the Montforthaus in Feldkirch is designed for concerts and conferences for up to 1150 people. Two linear arrays, each with 12 TTL33-A units, were installed here for the sound reinforcement of the stalls and the aisle.

- TTL 33-A



HDL 26-A

ACTIVE 2-WAY LINE ARRAY MODULE

The RCF HDL 26-A is a very compact, active 2-way line array system with 2-channel power amplifier for small and medium venues.

The advanced transducers and 2000-watt Class D power amplifier - one of the best in its class - provide an extended low-mid range and outstanding sound, whether stand-alone or integrated into a larger system via RDNet.

- 133 dB maximum sound pressure level
- 2-channel power amplifier 2000 watts
- Exclusive FiRPHASE technology
- 750 Hz crossover frequency for optimal vocal reproduction
- RDNet for network-based management
- 3-inch titanium diaphragm compression driver
- 2 x 6-inch neodymium high-power woofers
- 4PATH waveguide



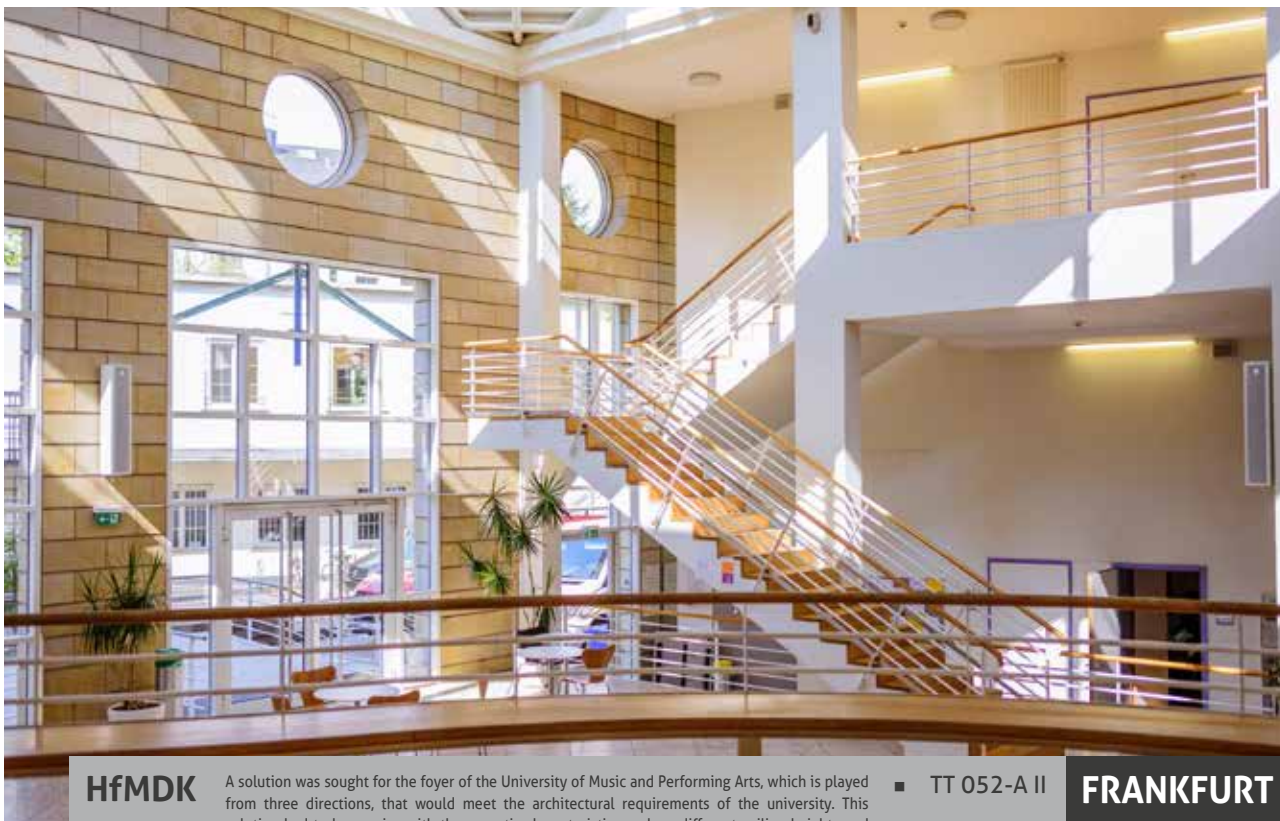

HfMDK

A solution was sought for the foyer of the University of Music and Performing Arts, which is played from three directions, that would meet the architectural requirements of the university. This solution had to harmonize with the acoustic characteristics such as different ceiling heights and two-story auditorium and varying sound depths between 15m and 25m.

■ TT 052-A II

FRANKFURT

TT 052-A II

ACTIVE 2-WAY LOUDSPEAKER

The TT 052-A II is an ultra-compact active speaker designed for high-quality near-field sound reinforcement indoors. The integrated 2-channel Class D power amplifier delivers 300 watts of power. Two powerful 5-inch neodymium woofers and a 1-inch compression driver on a constant directivity horn ensure optimum coverage. With networked control via RDNet, a powerful DSP and proprietary FiRPHASE technology, the TT 052-A II achieves 0 degree phase response and the familiar TT+ class sound quality.

- 2-channel Class D power amplifier, 300 watts
- Robust multifunctional housing
- 90° radial dispersion
- FiRPHASE for 0 degree phase response
- 2 x low distortion 5-inch neodymium woofer
- 1 inch compression driver, 1 inch voice coil



VIADRINA

The lecture, meeting, and concert hall of the European University VIADRINA in Frankfurt (Oder) is not only used by the university, but also rented out externally. For this purpose, an assertive audio system with electronically controllable RCF VSA beam-steering line speakers was installed.

- VSA

Königlicher Pferdestall

Conferences, symposia and concerts are held in the "Königlicher Pferdestall" hall of Leibniz University in Hanover. The historic ambience of the national monument has been stylishly renovated under strict conditions.

The RCF VSA line array loudspeakers master the balancing act between an unobtrusive appearance and the high expectations of modern acoustics.

- VSA



WMF33 EN

TWO-WAY WALL MOUNT SPEAKER

The WMF 33EN is a 2-way wall-mount loudspeaker that can be installed both horizontally and vertically. It is particularly suitable for the reproduction of background music in commercial environments, but can also be used for voice alarms and announcements due to its very good speech intelligibility and EN 54-24 certification. The plastic housing with magnetic steel front grille is particularly easy to install thanks to the intelligent mounting bracket. The terminal strips for fireproof input and output cables are made of ceramic material. A thermal fuse protects the connected cables and devices if the speaker is exposed to high temperatures.

- 2 x 3-inch full-range speakers with 1-inch dome tweeter.
- Selectable power (100 V): 40 W - 20 W - 10 W - 5 W - 2.5 W
- Characteristic sound pressure level 88 dB
- Color: Black (RAL 9005)
- Certified for voice alarm (EN 54-24)
- Ceramic terminal block for inputs and outputs
- Thermal fuse
- Connections integrated in the wall bracket
- Plastic housing with steel front grille





BORUSSIAPARK

The BORUSSIAPARK stadium can accommodate up to 54,000 spectators for Bundesliga matches. The high-quality sound reinforcement is realized by 144 linear array modules of the type HDL 20 WP. In order to achieve the vertical angularity, a special rigging design was developed here.

■ HL 20WP

MÖNCHENGLADBACH

HL 20WP

WEATHERPROOF PASSIVE LINE ARRAY MODULE

The HL 20-WP is a weatherproof, passive two-way linear array module (bi-amped). For its compact size, it has a particularly wide dispersion and convincing performance. Its amazing output power and dynamics, extreme precision and extended treble response in an extremely compact format make the HL 20-WP the ideal solution for outdoor sound reinforcement, live events or even fixed installations in theaters, concert halls or auditoriums. Connections to the power amplifier are made via a waterproof multi-pin connector. The aluminum front grille with special perforation is backed with an open-pore fiber layer with water-repellent woven fabric covering. The cabinet is made of birch multiplex and coated with an extremely resistant polyurea structure varnish.

- Extremely compact size
- Best power to size ratio
- Wide horizontal constant-directivity beam angle
- Numerous mounting points for attachment to custom array frames



S`HERTOGENBOSCH

The field hockey stadium of the Dutch first division team of s`Hertogenbosch has installed a new stadium announcement and audio sound system. Speech and syllable intelligibility were at the forefront of the investment.

The weatherproof P Series loudspeakers used provide intelligible stadium announcements and at the same time pleasant music and audio feeds.

- ACUSTICA P

BUNIAMSHOF

The traditional Buniamshof stadium was equipped with a new sound system. Significantly improved sound, as well as fewer emissions for the surrounding area were the goal of this new planning. Likewise, a uniform sound reinforcement was required, taking into account the acoustic runtimes.

The solution was provided by several clusters of decentrally installed loudspeakers of the ACUSTICA P series.

- ACUSTICA P



ACUSTICA P

Weatherproof 2-way speakers for outdoor use

Highly efficient, partially coaxial designs for outstanding music reproduction and speech intelligibility in compact, lightweight, weather-resistant enclosures. With their advanced design, P-Series speakers blend into any environment, and their rugged construction allows for indoor and outdoor use. The durable enclosures are made of extremely lightweight and UV-resistant polyethylene.

- High speech and syllable intelligibility
- Active MOSFET driver protection
- Weatherproof IP55 housing
- Fixed connection cables / Amphenol connectors





SIGNAL IDUNA PARK

Signal Iduna Park is the home stadium of Bundesliga team Borussia Dortmund and, with seating for up to 81,000 spectators, the largest soccer stadium in Germany. Here, over 196 TTL 33WP linear array modules have been providing powerful sound reinforcement and the best speech intelligibility for many years.

■ TTL 33WP

DORTMUND

TTL 33-A

ACTIVE 3-WAY LINE ARRAY MODULE

The TTL33-A II is a compact, wide dispersion, active three-way line array for medium to large sound reinforcement applications. Its high output power, extremely precise reproduction characteristics, and rugged and compact enclosure make the TTL33-A the ideal solution for outdoor sound reinforcement, high-quality fixed installations, and live applications.

- 3 Class-D power amplifiers with 1250W (RMS)
- 135 dB maximum sound pressure level
- 6 neodymium high power converters
- Networkable via RDNet



output

Professional audio, video & lighting

De Meerheuvel 10
5221 EA 's-Hertogenbosch
Tel: +31 (0)73 639 2600
info@outputnl.com
www.output.nl