



# **INSTALLED SOUND** SOLUTIONS









# RCF INSTALLED SOUND

## WE CARE ABOUT YOUR SOUND

RCF is a leading technology brand of professional audio equipment, transducers, electronics, DSP, and custom solutions for any sound and any place. Established in Italy in 1949, RCF has been committed to the perfect reproduction and amplification of sound for events and concerts, recording, public address, broadcast, and portable audio. RCF has consistently transformed the pro-audio industry, developing components and products in-house to ensure maximum quality and reliability to the end-user. The comprehensive catalog covers all aspects of the audio chain to satisfy sound engineers, architects, and system integrators.

## ENGINEERED FOR HUMAN BEINGS

The Installed Sound range represents a prominent chapter in the company's long history, continuously expanding one of the most comprehensive product portfolios offering dedicated integrated audio solutions with superior acoustic performance. This catalog includes speaker systems designed to meet all pro-audio contractors requirements for fixed installations like café or theme bars, retail outlets, places of worship, theatres, restaurants, live venues, dance clubs, theme parks, airports, hotels, railway stations, shopping malls, auditoriums, congress centers, sporting facilities, stadia, etc.

## RCF SOUND CULTURE

RCF is a leading technology brand of professional audio equipment, transducers, electronics, DSP, and custom solutions for any sound and any place. Established in Italy in 1949, RCF has been committed to the perfect reproduction and amplification of sound for events and concerts, recording, public address, broadcast, and portable audio. RCF has consistently transformed the pro-audio industry, developing components and products in-house to ensure maximum quality and reliability to the end-user.

## FOREFRONT TECHNOLOGY

Innovation comes first and foremost, thanks to the RCF R&D team, developers of many original products and technologies, such as the hyper-venting system, the inside/outside voice coil, the dual silicone spiders, and countless mechanical, digital, and leading-edge electronic solutions. RCF is one of the few loudspeaker companies worldwide that internally manufacture transducers, speaker systems, electronics, and software. All products feature RCF's exclusive designs and technologies.

## A REFERENCE IN INDUSTRY

RCF is always at the forefront of technologies and materials research, providing tools, documentation, technical support to help professionals deliver optimized sound to the listener. Training activities for all audio professionals and enthusiasts draw into 70 years of experience and knowledge of its engineers. The internal support engineering team is on hand to assist architects, system designers, or integrators during the design and customization of complex systems. Tangible technical expertise, modern Italian manufacturing facilities, and continuous technological refinement set RCF as an essential reference for all audio professionals and enthusiasts. RCF supports customers in its offices in the United States of America, France, Germany, Italy, Spain, the United Kingdom, and a network of more than hundreds of trusted distributors throughout the rest of the world.





posizione sorgenti - ricettori

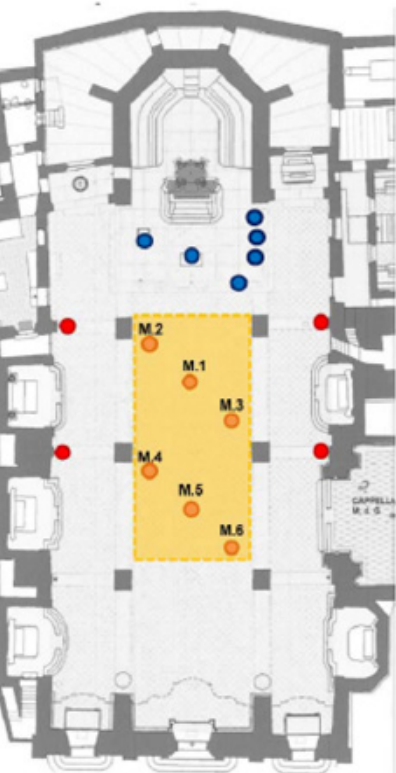

- Microfoni
- Altoparlanti
- Ricettori considerati

Rappresentazione grafica STI

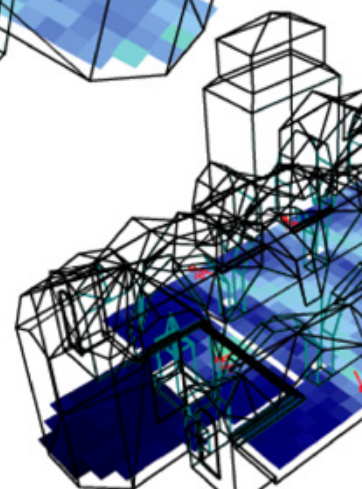
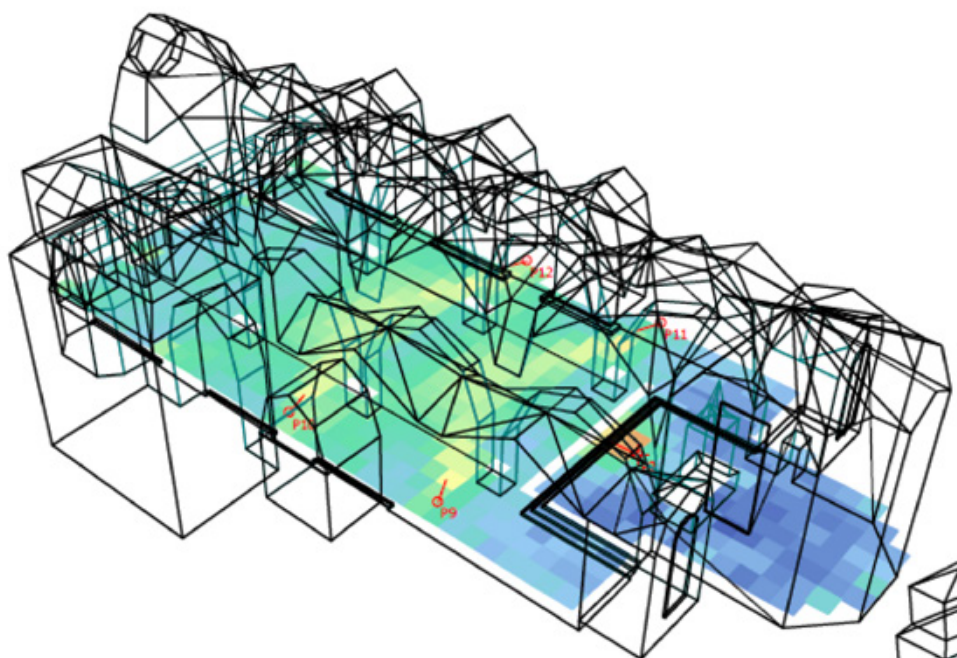
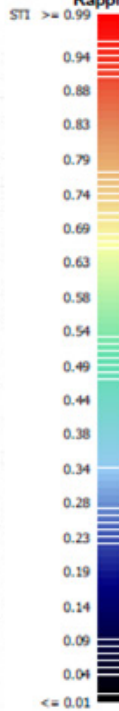





# ENGINEERING SUPPORT GROUP

## CUSTOMIZATION WITHOUT BOUNDARIES

Our Engineering Support Group works side by side with the R&D Department to create tailor-made equipment based on the client's real needs – complete with rigging accessories, signal processing, or custom mechanics. We are not only suppliers of standard products but also a team of highly skilled engineers who develop personalized audio solutions. Contact the RCF team to learn more about customization and color options to suit your unique environment. Each project has important benchmarks and we will help you to get the job done.

## RCF EXPERIENCE AT YOUR SERVICE

The direct involvement in particularly complex projects Worldwide is continually raising the know-how and reputation of our team of specialists that is considered one of the best Engineering Support Groups in our industry. A system design must always consider the environment's acoustics, the architectural and installation constraints, the maintenance costs, and the user's requirements. According to cost and performance requirements, the extensive and complete range of RCF products enables the Engineering Support Group to submit multiple design solutions optimized for each project.

RCF is committed to providing complete support, helping our customers choose the most suitable solutions for their projects to achieve the best results. This support team is crucial to RCF's continual success. We continue to invest in our knowledge and skill by expanding our engineering team of product specialists and the latest equipment and software technologies.

- **DESIGN PROPOSAL**

Based on supplied venue details, including environmental acoustic simulation, product list, block diagram, and speaker coverage mapping.

- **DESIGN VALIDATION**

Based on the client's design, we guide the proper selection and placement of RCF products.

- **DESIGN OF ALTERNATIVE SOLUTIONS**

Based on existing specs, we provide advice and improved system configurations based upon RCF products to optimize the installation.

- **ACOUSTICAL CONSULTANCY**

We help with the definition of the project's specifications in cooperation with architects and contractors.

- **ON SITE**

We provide system start-up and commissioning. RCF produces pre-wired racks on request, complete with connection diagrams and operation manuals.

## AUDIO ACADEMY TRAINING ACTIVITIES

Our training sessions are available in our worldwide educational program or can be customized according to the client's requirements. ESG members are involved in education and training activities where they can exchange information and ideas with consultants and contractors participating in the RCF Audio Academy program. RCF provides an extensive selection of courses and workshops covering several subjects such as new products, technologies, user cases, and in-depth professional training. Sessions are organized worldwide by our Instructors/Engineers and also in RCF Audio Academy facilities in Italy.

presentazione grafica livello di  
pressione acustica SPL (A)

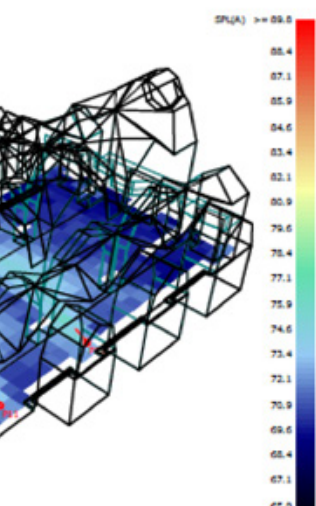









## Madison Luther Church - Wisconsin (USA)

In 1905 Evangelical Lutheran national church leaders envisioned a new mission in Madison, Wisconsin. The building stands tall in the heart of the University of Wisconsin campus despite the challenges it has faced over the decades including fires, threats of bankruptcy, a bombing, and cultural shifts with the denomination itself. These days, the church services the intergenerational faith community in the region of the state's capital.

Entering the nave, a stone living-water font greets worshippers into this architecturally stunning worship space. The floor plan is laid out in traditional cruciform design. With 40-foot high arched ceiling, a domed apse frames an ornate centerpiece that rises two stories above the altar with a statue of Jesus Christ looking down watching over his flock. On either side, ornamental organ pipes add to the majestic look with their 56-rank Austin pipe organ and Steere tracker organ.

In 2016, Luther Memorial leaders developed a new master plan for the church. Milwaukee-based Kubala Washatko Architects was called in to assist in restoring the church to its original grandeur. Having worked previously on audio systems with System Design Engineer Jason Keagy from Baraboo, Wisconsin-based Peak Systems Group, they were invited in to partner on the upgrades.

With a 100-foot throw from the speaker position to the furthest row of seats and the room exhibiting a nearly three-second delay time, Peak opted to use one VSA 2050 and one VSA 1250 on either side of the altar area. Using two cabinets also provided Peak with the ability to provide even coverage to both the front and transepts area with one VSA, the other covering the long-throw needs of the nave. In addition to the four VSA used to cover the sanctuary, Peak installed two VSA1250 in the rear to cover a choir loft area above the entranceway.

The result of coverage was "spot-on perfect," notes Mundth. "It was amazing that even in the last row, once you stood up you were outside the coverage area. The ability to target the congregation seating area is what makes the VSA such a useful solution." Senior Pastor Brad Pohlman concurs. "This has been a stunning improvement of sound quality. They really sound nice. I couldn't ask for any more out of them."

### Products installed



VSA 2050 II



VSA 1250 II



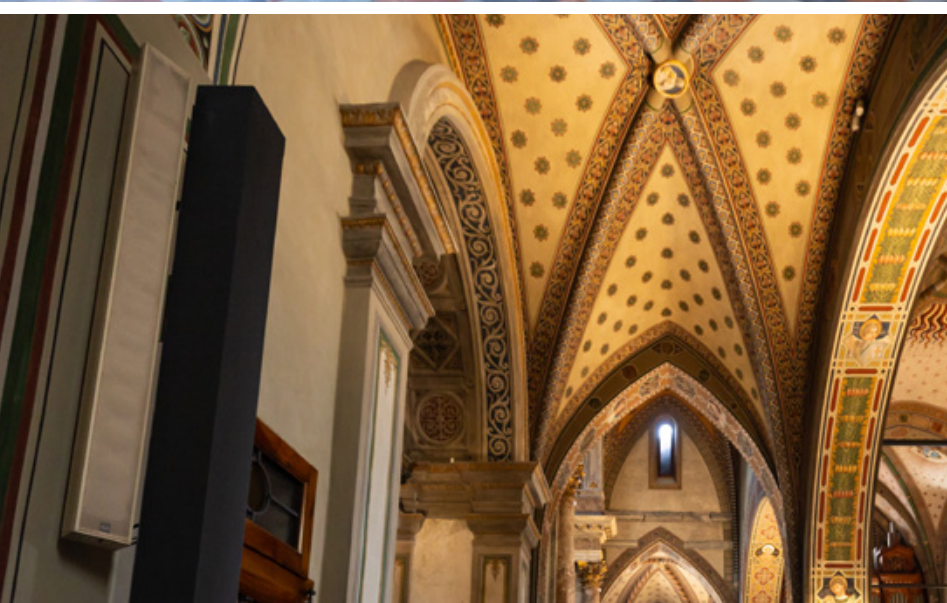





## Lugano Cathedral (CH)

Resplendent before beautiful views of Lake Lugano and the Alpine foothills, the cathedral of San Lorenzo rises above the town centre of the Swiss town of Lugano. Dating from the 11th century, it is one of Switzerland's oldest churches. A comprehensive restoration programme begun in 2011 included the recent installation of a new audio system based around digitally steerable VSA column speakers by RCF.

The system was installed by CEM Audio & Light services based in Bellinzona. "For the audio system we installed in the cathedral of San Lorenzo in Lugano, we selected RCF's VSA 2050 and VSA 1250 speakers, comments Virgilio Kohler, owner of CEM. "RCF column loudspeakers offer the ideal coverage pattern for difficult acoustic environments like the Cathedral of San Lorenzo," he added.

The RCF Engineering Support Group aided the customer in realising this system, taking into account the architectural conditions and adapting to both the building restrictions as well as the electro-acoustic limitations. The installation planners decided on digitally steerable speakers to provide the best possible speech intelligibility in an environment with natural reverb tails in the speech frequency range of up to 4 seconds.

"We placed four VSA 2050 on the columns along the side aisles in a symmetrical pattern. These cover the main nave area (the operating range for each speaker being up to 15 meters), providing crystal-clear speech intelligibility and a good signal-to-noise ratio across a wide frequency range. That lets the congregation experience and participate in the mass in a very immediate way," explain RCF technicians. "With its 20 individually steerable speakers, the VSA 2050 allows a vertical dispersion from 10° to 30° as well as vertical steering between 0° and -40°. This lets us focus the sound on the desired area and avoid unwanted reflections, guaranteeing the best possible speech intelligibility, even in environments with long natural reverb tails like this one."

The other main system component is made up of four VSA 1250 column speakers. These provide the same characteristics as the VSA 2050 but incorporate 12 speakers. This model was selected to cover the altar and visitors' areas which are used during larger events. For the choir, the engineers deployed the TT051-A, an ultra-compact active loudspeaker from RCF's professional TT+ range. This speaker can be subtly and unobtrusively integrated into any environment. All speakers are controlled individually and can be activated or deactivated as needed. Managing the entire system of VSA and TT+ speakers is accomplished via the RDNet control and monitoring software. The VSA speakers can be remote controlled using the Smart RC remote control and the VSA Remote app which is available for download in the Apple and Android stores.

### Products installed



VSA 2050 II



VSA 1250 II



TT 051-A II





## Church of San Prosdocimo - Padua (IT)



### Products installed



L 2406T



MQ 100L



S 5012



DPS 604X



IPS 2700

## Santo Spirito Church (IT)



### Products installed



VSA 2050 II



## San Joseph Cassina Rizzardi (IT)



### Products installed



VSA 2050 II



## Fiumicino Airport (IT)



### Products installed



VSA 2050 II











## Zarza Lounge Bar - Jaipur (India)

It was with a vision of innovation and uniqueness that husband and wife team of Komal and Shailendra Lalwani, opened Zarza to offer an exquisite dining and clubbing experience to the folks of India's Pink City (Jaipur). Sitting atop Dreamax Plaza, Zarza offers panoramic view of the city. The al-fresco multi-deck dining experience, with full bar, is the first in the state, while the two-layered night club, spread across 1350 sq ft, has a blend of seating and dance floor.

"Jaipur is an exotic destination for globetrotters and partygoers," says Shailendra. "People from across the world visit Jaipur for its historical significance and they love to party hard when the sun goes down,". He continues, "Zarza provides a whole new experience for the guests and to ensure the best sound system, we commissioned an RCF line array, which was supplied and installed by Hi-Tech Audio Systems of New Delhi. RCF immediately showed its potential at the launch party where Raghu Dixit headlined."

Shailendra himself was involved at every stage of the project. "Hi-Tech Audio Systems advised us in selecting the best sound for our club," he said, while praising the technical help provided by Kallol Nath, System Application Engineer of Hi-Tech Audio Systems and his team.

Kallol Nath added his own comments. "For me it's been an overwhelming experience to work on this plush project. We have taken the client's brief and concluded that the RCF HDL 20-A [line array] was the most suitable for Zarza." The venue is installed with hangs consisting of three elements per side, two RCF V218-S subwoofers an RCF QPS 9600 4-channel power amp and a BSS BLU 100 DSP processor. "The much needed punch of the sound is achieved without any pinching, unwanted frequencies or excess volume at the venue," he confirms.

Along with the technical team, Hi-Tech Audio Systems' sales team were also involved closely from day one of the project. Nirdosh Aggarwal, Director Sales of Hi-Tech Audio Systems, shares his experience. "Music is an important part of the concept of Zarza and therefore it was extremely important to have a sound system that worked perfectly in the early evening hours, when music should be more in the background, and later to be played at a higher level." Akshay Rajput, Sales Manager of Hi-Tech Audio System, further adds, "We understand that guests like to be able to talk with their friends as well as party, and as there are different zones spread across the venue, our technical team has cleverly placed the speakers to ensure an even sound flow. RCF is the best choice, both functionally and economically."

Rajan Gupta, Managing Director of Hi-Tech Audio Systems has been associated with various clients from the club and leisure industry across India over the years. He concludes, "It was a pleasure to carry out the installation in Zarza. The concept is to maintain an opulent ambience and at the same time to invest in a quality sound system that can deliver a world-class standard. The difference can only be felt once you visit Zarza and experience the power of RCF."

### Products installed



V 218-S



HDL 20-A



QPS 9600











## Izakaya Restaurant - Amsterdam (NL)

Exclusive restaurant chain IZAKAYA, which maintains several locations in Europe, offers a high-class and sophisticated Asian cuisine and combines it with a bar concept setting new standards continuously. Offering an exquisite gastronomic experience combined with various events IZAKAYA is a true hotspot in Amsterdam. At the beginning of 2019, IZAKAYA renewed its audio system and installed 12 C 3108-96 modules in Custom White. The Dutch audio specialist 24/7 Amsterdam was responsible for the technical implementation.

The C 3108 is an extremely versatile, unobtrusive, full-range 2-way loudspeaker system that integrates perfectly into the atmosphere of the IZAKAYA. With its wide dispersion angle, remarkable performance and efficiency, it offers a wide range of professional applications and is perfectly suited for the mixed use of the location. Due to its compact size, it is predestined for unobtrusive wall mounting or ceiling installation. The system delivers perfect sound and high performance without acting in the foreground within the location - just the way it should be. The mixed use of the IZAKAYA location in Amsterdam as a restaurant, bar, enriched with many events, including live music, demands a lot of flexibility talking about the sound system.

"That's exactly why we chose the C 3108 from RCF", says Mike Ho from 24/7 Amsterdam about the location IZAKAYA and choosing RCF. "The Custom White modules integrate perfectly into the stylish ambience of the IZAKAYA location in Amsterdam. The assertiveness, comprehensibility and the necessary adaptability make RCF's C 3108 the perfect choice for the IZAKAYA."

The high-frequency section is a constant directivity horn loaded to a 1.4" compression driver with a 1.5" diaphragm assembly for smooth, wide dispersion. The low-frequency transducer is an 8" woofer with a 2" voice coil.

The IZAKAYA is part of the Entourage Group and is present in Amsterdam, Hamburg, Munich and Ibiza and has extraordinary competence in the Asian gastronomy. The concept combines the traditional Japanese dining experience with extravagant Japanese cuisine and adds a South American touch and high-quality cocktails to take it to a new level. IZAKAYA offers pure relaxation and enjoyment in an 'urban, chic' ambience. The combination of Asian Kitchen & Bar with events makes IZAKAYA one of the hottest locations in Amsterdam, which is truly not poor in events.

### Products installed



C 3108-96











## Antrim Forum - Belfast (UK)

The Kingspan Stadium in Belfast, home of Ulster Rugby, has completed a major upgrade of its stadium in the Ravenhill area of Belfast. The construction of three covered stands, from open terraces into covered all-seater stands, are designed to match the fourth, Premium Stand, which includes 20 corporate boxes and was developed in 2008-2009.

The latest incremental upgrade includes a new RCF PA/VA distributed sound broadcast system, linked to a newly-provided Fire Alarm system, to create a communications infrastructure that complies with BS5839 Part 8 standard.

Explaining the shortcomings of the pre-existing system, Managing Director Aaron McKeown said, "The old system was not flexible in terms of paging and music routing. Also, there was no local volume control in any of the zones." Their answer was to specify an RCF DXT 7000 multi-zone sound broadcast system.

As ever, the biggest challenge faced by the installation team was working in a harsh, live sports environment, redolent with echo and reverberation — and in the case of the swimming pools, high humidity. But they were able to specify appropriate loudspeakers to suit budget and environment, including nearly 180 RCF ceiling speakers.

However, the most powerful sound reinforcement is confined to the reconfigurable main sports hall where a pair of RCF HDL 20-A three-element line array hangs are reinforced by a pair of HDL 18-AS subwoofers at the rear of each hang.

Another progressive decision, inspired by their solution at another leisure centre, was in designating six high-powered, purpose-designed P 2110-T single 10" coaxial waterproof speakers for the swimming pool areas. These not only suit the environment but will deliver messages in the 'live' environment audibly and with high intelligibility.

In the Tenpin Bowl there are eight Media Series M 801 8" enclosures, and a further four of these speakers in the dance studios. Separate plug-in points are provided for local systems in the Dance Studio and Spinning Classes. RCF ceiling speakers, distributed through the complex on 100V line, comprise 146 x PL 6X and 31 PL 8X, with 23 compact DM 41 surface-mount wall speakers feeding the corridors and peripheral areas.

Control is from one central 42U rack room containing three 4-channel UP 8504 and six 2-channel UP 8502 100V line amplifiers, which drive the ceiling speakers and DM 41's. Meanwhile, a pair of IPS 700 and an IPS 1700 amplifier feed the low impedance Media speakers, with all matrixing carried out in the main MU 7100 processor, which stores pre-recorded messages. Also in the rack is a DX 4008 4-in/8-out processor for the low-impedance speaker control.

### Products installed



P 2110T



HDL 20-A



HDL 18-AS



M 801



DM 41



PL 8X



PL 6X



DX 4008



IPS 1700









## Olympic Swimming Pool - Győr (HU)

Situated in the western Hungarian city of Győr, the new state-of-the-art Aqua Sport Center is based around a full 50x25-metre Olympic sized swimming pool.

Built on an 10,000 sq. meter site, much of it in metal and glass, the viewing area comprises 800 fixed seats and 400 optional chairs, while ancillary features include a 16x10 meter educational pool, two saunas and plunge pool, jacuzzi, relax room, fitness rooms and changing rooms.

At the planning stage last September the need for a good sound system to function intelligibly in this reverberant space was recognized and according to Imre Makkay from Chromasound Kft, RCF's long-term Hungarian distributors, one of their local system integrators, G-Sound had the opportunity to fulfil the specification with an RCF solution, having already successfully outfitted the Audi Arena Győr with the brand.

The owner of the company, József Gricz wrote the specifications — which were readily accepted by the pool management — and conducted an electro-acoustical simulation.

From RCF's large product portfolio he based his system design around ten P 4228 indoor/outdoor, weatherproof (IP55-rated) wide-dispersion, two way loudspeakers, designed to offer substantial power and efficiency. The HF section is a constant directivity CMD horn loaded with a 1.4" RCF precision compression driver with a 2.5" diaphragm assembly for wide dispersion while the LF transducer is a double 8" woofer with a 2.5" voice coil.

There are three main grandstands surrounding the pool and down both long sides they have installed four speakers, and a pair on each end that includes standing and seated VIP areas in one of the corners, with a gallery.

The speakers are hung directly above the water and installed horizontally under the electrical cable trays on uniquely designed, certified, stainless steel consoles. "We were lucky because the electrical cable tray consoles were sufficiently strong to support the lightweight speakers," said Gricz. "We've defined distances from the seats to the speakers, mindful of the horn's 110° x 60° dispersion angles."

The speakers are divided into five zones, and with a dedicated DX 4008 4-in/8-out digital system controller installed in the technical room, there are free I/O's for future needs.

Each half of the pool area is served by its own amplification rack positioned close to the speakers in order to shorten the low impedance cable runs. The system is driven by a total of five RCF IPS 3700 stereo amps, delivering up to 2 x 1500W RMS@4Ω.

The challenges faced by G-Sound and Chromasound were all the result of the many flat surfaces (glass, water, and walking areas), and with minimal acoustic treatment, the average time decay was 4.5 sec. "Our main goal was to reproduce sound accurately and intelligibly to populated areas — not only the spectators in the stands but coaches pool-side and competitors on the starting blocks.

### Products installed



P 4228



IPS 3700



DX 4008











## Lotus Sxm Club - Simpson Bay (St Maarten)

Located in Simpson Bay St Maarten, Lotus is a brand-new concept club created by Caribbean powerhouse duo Manny Almirakis & Fred Bianco, the same team behind Tantra SXM. After Hurricane Irma swept through the island and destroyed the old venue, the team rebuilt the venue. Six months later, Lotus was born. With its state of the art RCF sound system along with all new lighting setup and chic mosaic decor the venue is back as the Caribbean's number one hot spot.

"The Lotus dancefloor measures 400 sqm, and 8 m floor to ceiling," states Matthieu Cherix, the installer. "I chose V-Max series because I had already used it with success for another installation, and for me it's the best choice for a nightclub. It is the first time that we have used the RCF QPS 9600 amplifiers and I'm very pleased with the result. We started with four V 35 and two V 218-S in order to immediately have the best sound we could after the hurricane. We plan to add four more V 10 for the next season, as delays in the same room." Matthieu worked with the RCF Engineering Support Group for the acoustic simulation in order to get the best performance.

"To achieve a strong and powerful bass, I built a concrete box to install the two V 218-S inside, with DJ booth on top. The DX 4008 processor drives the system, main output and monitoring (which consists of two C MAX 4112 nearfield high-powered monitors). V 35 are used in parallel (4 ohm) on two bridged amplifier channels. Each V 218-S are also on two bridged channels. The C MAX 4112s are on a single channel with a reduced power output. I love QPS for that, you can do whatever you want with the best results."

### Products installed

---



C MAX 4112



V 35



V 218-S



QPS 9600



DX 4008



## Adam & Siam - Amsterdam (NL)



### Products installed



MR Series



COMPACT Series

## Manō Poké Hawaiian Restaurant - Modena (IT)



### Products installed



MQ 50





Cannibale Royale - Amsterdam (NL)



Products installed



C 3108-96

Loft Rooftop - Novi Sad (Serbia)



Products installed



M 601



MQ 80P



S 5012



DPS 604X









## QC Terme Resorts (IT)

At QC Terme Resorts, elegant spaces combine harmoniously with the latest technologies. Through skilful design, realisation and management of these spas and wellness centres, the “Salus Per Aquam” wellbeing philosophy of ancient Rome is brought back with a modern twist. Evolution over time has transformed the spa into a multi-sensory experience in which to indulge in pleasant moments of total relaxation. QC Terme’s cutting-edge centres are located in Bormio (Bagni Nuovi and Bagni Vecchi), Pré-Saint-Didier, Milan, Turin, Rome and San Pellegrino, with prestigious new locations current under construction in Italy and worldwide.

One of the most recent to open, at the heart of the Dolomites UNESCO World Heritage Site, a QC spa immersed in the unspoilt nature of the Val di Fassa. QC Terme Dolomiti slots into the landscape with maximum respect for this natural setting. The Ladin culture is revived in the spaces of the spa, through typical furnishings of the local artisan tradition. Three levels of wellbeing, for a total of 4300 square metres, plus swimming pools and outdoor areas that allow you to enjoy the benefits of “forest bathing”, immersion in nature as preventive medicine. The sauna also transforms into a cinema: the Sauna Chèder is the first to offer guests the opportunity to enjoy short films dedicated to nature.

“The wellbeing experience involves all of the guest’s senses, so the sound aspect is also part of that package”, comments Gilles Cheney, QC Terme’s Audiovideo Artistic Director, specifying that “RCF is an internationally recognised company that delivers professional products of recognised quality. But the most important aspect, which proved to be their strength, was the company’s ability to always respond to our needs, to grow, to find custom solutions wherever our demands might have seemed an obstacle”.

RCF integrated systems allow easy remote control, total safety and guaranteed function in any type of application, including locations with high humidity, outdoor spaces or with particular customisation requirements. Cheney reiterates that “QC Terme locations are the only ones to offer guests ‘diffused’ wellbeing. Sound envelops, captures, recalls: the QC experience is also a sound experience”.

### Products installed



MQ 80P



DM 61



DM 41



PL 6X



UP 8504



UP 8502



UP 2162



# COLUMN SPEAKERS

Advanced column array speakers with fixed or controllable vertical directivity. Suitable for acoustically critical applications or spaces with architectural constraints.

The VSA II system allows the audio signal to be addressed exactly to the listening area, avoiding the radiation of the acoustic energy to ceilings and empty floors; this eliminates any bad reflections that would affect speech intelligibility, mainly in critical environments with high reverberation. VSA offers a precise directivity and control to give high intelligibility performance with wide frequency

response, high-dynamics and coherence at distance. Thanks to the reliable and powerful amplifiers, the accurate speaker design, and the high efficiency of the digital technology, VSA II is able to achieve an extended and stable coverage, preserving at the same time a smooth uniform horizontal coverage.

## RDNET

The RCF RDNet is the perfect tool to help you to configure your VSA II system setup in any venues. The software helps to monitor and control all individual speakers with its own DSP setting and to secure the best performance of the system configuration. RDNet is a secure and robust management for small, medium, and arena-sized sound

systems as well as complex and extended installations. Based on a proprietary network protocol RDNet provides straightforward monitoring and intuitive control of the RCF audio system down to every connected device/object.

## VSA SMART RC

The VSA-RC is an easy way to control the VSA speakers through the VSA Remote App available on iOS or Android. The following data are configurable on each VSA through the VSA-RC remote control:



### VSA 2050 II

- 20 x Class D, 50 W amplifiers
- 96 dB SPL Max
- 650 W RMS Power
- 1300 W Peak Power
- 100 ÷ 18000 Hz Freq. Range
- Vertical Coverage Beam from 10° to 30°
- Vertical Steering from 0° to -40°
- 20 x 3.5" neo full range speakers
- Standard installation accessories included
- Extruded aluminium body



### VSA 1250 II

- 12 x Class D, 50 W amplifiers
- 94 dB SPL Max
- 650 W RMS Power
- 1300 W Peak Power
- 100 ÷ 18000 Hz Freq. Range
- Vertical Coverage Beam from 10° to 30°
- Vertical Steering from 0° to -40°
- 12 x 3.5" neo full range speakers
- Standard installation accessories included
- Extruded aluminium body





The L 2406-T is a full range high intelligibility compact 3 way column speaker array with vertical controlled directivity for medium to large size installations. It is equipped with six 5" woofers and four 1" dome tweeters mounted in front of the two central woofers. This particular design permits coherent sound dispersion minimizing lobing in a very compact enclosure. The two central woofers are controlled differently from the other four

because of the tweeters in front of them, in order to improve the directivity providing a true cardioid column operation. The wide coverage horizontal angle and the controlled vertical dispersion allow correct sound reproduction serving a wide area and assistance in limiting feedback and reverberated sound. A speech filter can be activated for enhancing the voice frequencies and improving speech intelligibility.

The crossover is designed to avoid secondary lobing creation. Mounting accessories are provided and are designed to keep the column as close as possible to the wall and simplify the installation allowing suitable tilting. The L 2406-T can be used connected to a low impedance

amplifier to handle 200 W RMS power. It also includes a 60 W line transformer for 100 V systems. The crossover is equipped with a circuit to protect the four 1" dome tweeters.



### VSA 850 II

- 12 x Class D, 50 W amplifiers
- 93 dB SPL Max
- 650 W RMS Power
- 1300 W Peak Power
- 100 ÷ 18000 Hz Freq. Range
- Vertical Coverage Beam from 10° to 30°
- Vertical Steering from 0° to -40°
- 8 x 3.5" neo full range speakers
- Standard installation accessories included
- Extruded aluminium body



### L 2406T

- 126 dB SPL Max
- 200 W RMS Power
- 800 W Peak Power
- Directivity Index Q: 9
- 100 ÷ 20000 Hz Freq. Range
- 150° x 30° coverage angle
- 4 x 1" Dome Tweeter
- 6 x 5" Woofer
- 2000 Hz Crossover Frequencies
- EUROBLOCK connector



# COMPACT SERIES

## TWO-WAY PASSIVE SPEAKERS

The Compact Series is a full range extremely versatile wide-dispersion, two-way loudspeaker system offering substantial power and efficiency for several professional applications.

The Compact Series is a powerful and highly advanced range of passive near-field two-way direct radiating loudspeaker systems based on CMD - Coverage Matched Design technology, designed to guarantee a smooth

transition between high frequency horns and low frequency transducers directivity. Featuring several mounting points and handles it simplifies permanent install applications.

### EASY RIGGING

The cabinet is made of Baltic birch (heavy duty painted) and allow different installation options, as it is equipped with top and bottom 'Multiplates' for either wall or suspended mounting with chains.

Installation points are available on its rear panel as well. The steel front grille is protected with a double layer polyurethane fabric. The front RCF logo is easily rotatable.



### C 5215 SERIES

- 500 W RMS Power
- 2000 W Peak Power
- 48 ÷ 20000 Hz Freq. Range
- 2.5" C. Driver
- 15" Woofer
- Crossover 1.2 kHz

### LOW FREQUENCY

The low-frequency transducer is an 15" RCF PRECISION woofer with a 3" voice coil.

#### C 5215-99

- 133 dB SPL Max
- Direc. Index Q: 11
- 90° x 90° CMD

#### C 5215-96

- 133 dB SPL Max
- Direc. Index Q: 12
- 90° x 60° CMD

#### C 5215-94

- 133 dB SPL Max
- Direc. Index Q: 14
- 90° x 40° CMD

#### C 5215-66

- 134 dB SPL Max
- Direc. Index Q: 20
- 60° x 60° CMD

#### C 5215-64

- 134 dB SPL Max
- Direc. Index Q: 20
- 60° x 40° CMD





### LICC - Low Impedance Compensated Crossover

The system includes a high-level crossover network that features lower than conventional induction values. Its benefits are delay reduction, reduced phase shift and superior transient response for improved audio performance and stability.

### CMD - Coverage Matching Design

RCF exclusive CMD technology helps guarantee an optimal transition between the high frequency horn polar pattern and the low frequency woofer directivity. The horn can be rotated, allowing to install the loudspeaker either vertically or horizontally.

### HIGH FREQUENCY

The hi-frequency transducer is a 1.4" RCF PRECISION compression driver with a 2.5" voice coil for smooth, wide dispersion.



### C 5212 SERIES

- 500 W RMS Power
- 2000 W Peak Power
- 54 ÷ 20000 Hz Freq. Range
- 2.5" C. Driver
- 12" Woofer
- Crossover 1.2 kHz

### LOW FREQUENCY

The low-frequency transducer is an 12" RCF PRECISION woofer with a 3" voice coil.

#### C 5212-99

- 132 dB SPL Max
- Direc. Index Q: 13
- 90° x 90° CMD

#### C 5212-96

- 132 dB SPL Max
- Direc. Index Q: 13
- 90° x 60° CMD

#### C 5212-94

- 132 dB SPL Max
- Direc. Index Q: 13
- 90° x 40° CMD

#### C 5212-66

- 133 dB SPL Max
- Direc. Index Q: 16
- 60° x 60° CMD

#### C 5212-64

- 133 dB SPL Max
- Direc. Index Q: 16
- 60° x 40° CMD



# COMPACT M SERIES

## MULTIPURPOSE TWO-WAY FULL-RANGE SPEAKER SYSTEM

Suitable for a wide range of applications. Its sound quality and compactness combine with an elegant design and accurate finishing to make the COMPACT M series the perfect choice for any environment.

Engage your audience with this multipurpose two-way passive speaker series, ideal for a wide range of installed applications. The sound quality and the neutral design make COMPACT M series suited to every environment,

providing excellent acoustic performance for both background and foreground music. With a complete range of solid wood cabinets, multiple rigging points and accessories, installation time is minimal.

### IMPROVE THE AUDIO ATMOSPHERE

Music supports engagement and improves the feeling of hospitality in the environment, especially if the perceived sound quality is higher. RCF's Compact M Series is designed specifically for optimal performance in both background music and high-powered foreground audio.

### OPTIMAL SOUND PERFORMANCE

The available SPL level and low distortion characteristics go way beyond what is usually expected of a compact solution.

### ENGAGE YOUR CUSTOMERS

Compact dimensions and an impressive ratio of size/weight to SPL output: Let your audience enjoy an immersive musical experience.



#### COMPACT M 12

- 129 dB SPL Max
- 300 W RMS Power
- 1200 W Peak Power
- Directivity Index Q: 9
- 55 ÷ 20000 Hz Freq. Range
- 90° x 70° coverage angle
- 1.4" C. Driver
- 12" Woofer
- 1800 Hz Crossover Frequencies
- 4 pole EUROBLOCK connector



#### COMPACT M 10

- 128 dB SPL Max
- 300 W RMS Power
- 1200 W Peak Power
- Directivity Index Q: 9
- 60 ÷ 20000 Hz Freq. Range
- 90° x 70° coverage angle
- 1.4" C. Driver
- 10" Woofer
- 1800 Hz Crossover Frequencies
- 4 pole EUROBLOCK connector



#### COMPACT M 08

- 128 dB SPL Max
- 200 W RMS Power
- 800 W Peak Power
- Directivity Index Q: 9
- 60 ÷ 20000 Hz Freq. Range
- 90° x 70° coverage angle
- 1.4" C. Driver
- 8" Woofer
- 1800 Hz Crossover Frequencies
- 4 pole EUROBLOCK connector





## WIDE COVERAGE, ELEGANT DESIGN

Smooth and wide frequency response with constant coverage, thanks to the CMD wave-guided compression driver.

## THE TRANSDUCERS INNOVATORS

High sensitivity and Hi-Fi sound quality with meticulously selected components.

## SMOOTH INSTALLATION

COMPACT M speakers embody the functionality and style you expect of Italian design, always in harmony with the installation environment. Available in a wide range of models for all sizes and power levels, the Compact M series gives you the optimal combination to match with any coverage need. Moreover, the rotatable horn and RCF logo allow both vertical

and horizontal speaker installation.

All models are built of high-quality wood, with multiple rigging points for a convenient flying/hanging installation. Thanks to the range of accessories, installation time is minimal. If needed, the EUROBLOCK connection panel can be replaced with a female Neutrik SpeakON one.



### COMPACT M 06

- 116 dB SPL Max
- 100 W RMS Power
- 400 W Peak Power
- Directivity Index Q: 7
- 60 ÷ 20000 Hz Freq. Range
- 120° x 80° coverage angle
- 1.3" Neo Dome Tweeter
- 6" Woofer
- 2200 Hz Crossover Frequencies
- 4 pole EUROBLOCK connector



### COMPACT M 05

- 115 dB SPL Max
- 80 W RMS Power
- 320 W Peak Power
- Directivity Index Q: 7
- 70 ÷ 20000 Hz Freq. Range
- 120° x 80° coverage angle
- 1.3" Neo Dome Tweeter
- 5" Woofer
- 2200 Hz Crossover Frequencies
- 4 pole EUROBLOCK connector



### COMPACT M 04

- 110 dB SPL Max
- 60 W RMS Power
- 240 W Peak Power
- Directivity Index Q: 6
- 90 ÷ 20000 Hz Freq. Range
- 120° x 120° coverage angle
- 1" Neo Dome Tweeter
- 4" Woofer
- 3000 Hz Crossover Frequencies
- 4 pole EUROBLOCK connector



# MAX SERIES

## FULL-RANGE TWO-WAY PASSIVE SPEAKERS

The MAX series has been designed as a multi-purpose speaker, to achieve the best nearfield quality, vocal coherence, and a stable tonal balance even at full volume.

The full-range passive two-way RCF MAX series has been designed as a multi-purpose speaker, to achieve the best

nearfield quality, vocal coherence, and a stable tonal balance even at full volume.

### PERFECTLY TUNED CROSSOVER

The MAX Series features a custom-designed mid-freq shaping for close distance listening on a perfectly tuned crossover to ensure the best frequency and phase response. The LICC crossover design includes electronic protection on high-frequency device.

### DESIGNED TO PERFORM

The RCF MAX series and its components are designed inside RCF's laboratories and feature superior transducers. Equipped with a rotatable horn with 90° x 70° dispersion pattern.



#### V 45

- 137 dB SPL Max
- 1800 W RMS Power
- 7200 W Peak Power
- Directivity Index Q: 10
- 30 ÷ 20000 Hz Freq. Range
- 90° x 40° coverage angle
- 4" Neo C. Driver
- 2 x 15" Woofer



#### V 218-S

- 141 dB SPL Max
- 3000 W RMS Power
- 12000 W Peak Power
- 30 ÷ 250 Hz Freq. Range
- 2 x 18" Woofer



#### X MAX 12

- 129 dB SPL Max
- 400 W RMS Power
- 1600 W Peak Power
- Directivity Index Q: 9
- 60 ÷ 20000 Hz Freq. Range
- 90° x 70° coverage angle
- 1.4" C. Driver
- 12" Woofer



#### X MAX 10

- 128 dB SPL Max
- 350 W RMS Power
- 1400 W Peak Power
- Directivity Index Q: 11
- 65 ÷ 20000 Hz Freq. Range
- 90° x 70° coverage angle
- 1.4" C. Driver
- 10" Woofer





## CABINET & MECHANICS

All Max Series cabinets are built in heavy-duty birch plywood coated with black textured epoxy. A sturdy black metal grille protects the front, and an acoustically transparent sound foam backing on the inside of the grille ensures protection from dust and humidity. The base of each speaker includes a robust

steel pole socket for mounting on a stand or a subwoofer pole. Included are rigging points to fly the speakers for maximum architectural freedom on any installation. Threaded inserts are provided for optional mounting hardware in Installed Sound Applications.

## EASY RIGGING

The base of each speaker includes a robust steel pole socket for mounting on a stand or a subwoofer pole. Threaded inserts are provided on all sides for optional mounting hardware. Included are multiple rigging points to fly the speakers for maximum architectural freedom in any installation.

## ROBUST WORKHORSE

All MAX Series cabinets are built-in plywood coated with black textured acrylic paint. A sturdy powder-coated metal grille protects the front, and an acoustically transparent sound foam backing on the inside of the grille ensures protection from dust and humidity.



### C MAX 4112

- 130 dB SPL Max
- 400 W RMS Power
- 1600 W Peak Power
- Directivity Index Q: 11
- 60 ÷ 20000 Hz Freq. Range
- 90° x 70° coverage angle
- 1.75" Neo C. Driver
- 12" Woofer



### C MAX 4110

- 128 dB SPL Max
- 350 W RMS Power
- 1400 W Peak Power
- Directivity Index Q: 11
- 65 ÷ 20000 Hz Freq. Range
- 90° x 70° coverage angle
- 1.75" Neo C. Driver
- 10" Woofer



### E MAX 3112

- 129 dB SPL Max
- 350 W RMS Power
- 1400 W Peak Power
- Directivity Index Q: 11
- 55 ÷ 20000 Hz Freq. Range
- 90° x 70° coverage angle
- 1.5" Neo C. Driver
- 12" Woofer



### E MAX 3110

- 128 dB SPL Max
- 300 W RMS Power
- 1200 W Peak Power
- Directivity Index Q: 11
- 60 ÷ 20000 Hz Freq. Range
- 90° x 70° coverage angle
- 1.5" Neo C. Driver
- 10" Woofer



# P SERIES

## PASSIVE COAXIAL SPEAKERS IN ROTO-MOLDED PLASTIC RESIN

Highly efficient coaxial designs offering excellent music and speech intelligibility in a compact, lightweight, and weatherproof enclosure.

The RCF P Series are highly efficient two-way designs offering excellent music and speech intelligibility in compact lightweight weatherproof design cabinets constructed with a heavy-duty roto-molded plastic resin UV-stabilized material. P Series speaker systems offer environmental protection up to the highest IP standard rating.

The design aesthetics of the P Series is suitable for outdoor applications as well as indoor installations in tough environments.

The front grille construction and included bracket are made of aluminum and stainless steel in all models.



### P 6215

- 134 dB SPL Max
- 600 W RMS Power
- 2400 W Peak Power
- Directivity Index Q: 13
- 75 ÷ 20000 Hz Freq. Range
- 60° x 60° coverage angle
- 2.5" C. Driver
- 15" Coaxial neo Woofer
- IP 55 Protection Grade



### P 3115T

- 129 dB SPL Max
- 300 W RMS Power
- 1200 W Peak Power
- Directivity Index Q: 13
- 75 ÷ 20000 Hz Freq. Range
- 90° x 60° coverage angle
- 1.5" C. Driver
- 15" Coaxial Woofer
- IP 55 Protection Grade



### P 2110T

- 124 dB SPL Max
- 200 W RMS Power
- 800 W Peak Power
- Directivity Index Q: 11
- 95 ÷ 20000 Hz Freq. Range
- 90° x 40° coverage angle
- 1.5" C. Driver
- 10" Coaxial Woofer
- IP 55 Protection Grade



### P 8015S

- 132 dB SPL Max
- 800 W RMS Power
- 3200 W Peak Power
- 50 ÷ 200 Hz Freq. Range
- 15" neo Woofer
- IP 55 Protection Grade





## ALL-WEATHER PERFORMANCE

The single-piece rotomolded cabinet is fully UV protected, equipped with multiple brass inserts and a corrosion-resistant 316P stainless steel U-bracket. Connections to the amplifier are made through a watertight multi-pole connector. The front aluminum grille is powder coated with water-repellent backing material, front logo is rotatable. All P series speakers meet IP55 standard requirements (International Protection Rating), suitable for indoor and outdoor applications.

## VERSATILITY FOR ANY APPLICATION

Focusing on outdoor and indoor large spaces, P Series speakers are capable of true, concert-level high performance in a compact enclosure, installed individually or coupled in array configurations. Featuring coaxial, line source, and subwoofers speakers, all modules embed RCF Precision transducers, horns, and waveguides for optimal coverage and clarity. The cabinet's design with coaxial or coplanar transducers and horns produces identical left and right coverage, capable of delivering serious sonic horsepower within the stadium while maintaining intelligibility and even coverage at every seat.



### P 5228-L

- 131 dB SPL Max
- 500 W RMS Power
- 2000 W Peak Power
- Directivity Index Q: 11
- 80 ÷ 20000 Hz Freq. Range
- 90° x 20° coverage angle
- 1.75" C. Driver
- 2 x 8" neo Woofers
- IP 55 Protection Grade



### P 4228

- 129 dB SPL Max
- 400 W RMS Power
- 1600 W Peak Power
- Directivity Index Q: 9
- 80 ÷ 20000 Hz Freq. Range
- 110° x 60° coverage angle
- 2.5" C. Driver
- 2 x 8" Woofers
- IP 55 Protection Grade



### P 3108

- 129 dB SPL Max
- 300 W RMS Power
- 1200 W Peak Power
- Directivity Index Q: 11
- 80 ÷ 20000 Hz Freq. Range
- 90° x 60° coverage angle
- 2.5" C. Driver
- 8" Woofers
- IP 55 Protection Grade



### P 1108T

- 121 dB SPL Max
- 100 W RMS Power
- 400 W Peak Power
- Directivity Index Q: 11
- 80 ÷ 20000 Hz Freq. Range
- 90° x 60° coverage angle
- 1.5" C. Driver
- 8" Woofers
- IP 55 Protection Grade



# ART 3 SERIES

## MULTIPURPOSE TWO-WAY PASSIVE SPEAKERS

The optimum choice for high powered vocal applications, music playback and demanding musicians.

During the last twenty years RCF transitioned into the forefront of passive and active loudspeaker technology, from the introduction of the original ART series to many prominent speaker systems conceived and designed in our laboratories.

We have over the years grown to understand the best ways to use the extra degree of freedom that an injection moulded cabinet offers and in interpreting how such a

cabinet and transducers interact each other.

The ART passive speakers have been designed for live sound reinforcement as well as distributed sound systems for clubs and music venues.

All models are equipped with extremely high quality RCF Precision compression drivers and high power woofers to offer unparalleled performance in both fixed installation and live situations.

### BRING ART WITH YOU

The sturdy, ergonomic cabinet is easy to carry, thanks to either the handle at the top or the practical handles on both sides. The base of each speaker includes a steel pole socket for mounting on a stand or on a subwoofer pole. Stability and safety are assured. Internal reinforcement prevents any deformation of the cabinet.

### SUPERIOR TRANSDUCERS

Woofers and compression drivers are precision built taking advantage of RCF's technologies and a wealth of professional knowledge and experience dedicated to achieving extremely high standards.

### YOUR STAGE PARTNER

Every ART model can be used in the standard or stage monitor configuration.



#### ART 725 MK4

- 133 dB SPL Max
- 650 W RMS Power
- 55 ÷ 20000 Hz Freq. Range
- 1400 Crossover Freq.
- 90° x 60° coverage angle
- IN / OUT Speakon
- 3" Neo C. Driver
- 15" Neo Woofer



#### ART 315 MK4

- 129 dB SPL Max
- 300 W RMS Power
- 50 ÷ 20000 Hz Freq. Range
- 1800 Crossover Freq.
- 90° x 60° coverage angle
- IN / OUT Speakon
- 1.5" C. Driver
- 15" Woofer



#### ART 312 MK4

- 128 dB SPL Max
- 300 W RMS Power
- 50 ÷ 20000 Hz Freq. Range
- 1800 Crossover Freq.
- 90° x 60° coverage angle
- IN / OUT Speakon
- 2.5" C. Driver
- 12" Woofer



#### ART 310 MK4

- 127 dB SPL Max
- 300 W RMS Power
- 50 ÷ 20000 Hz Freq. Range
- 1800 Crossover Freq.
- 90° x 70° coverage angle
- IN / OUT Speakon
- 1.5" C. Driver
- 10" Woofer



# SUB SERIES

## BASS REFLEX AND BANDPASS SUBWOOFERS

Highly efficient design, various configurations, particularly well-suited matching subwoofer in high-quality sound systems for clubs, bars and cafes, theatres, multimedia, and corporate A/V applications.

### POWERFUL LOWS

RCF subwoofers are the first choice of many sound engineers, due to their very high SPL levels at very low frequencies, smaller dimensions compared to the competitors, and impressive size/weight to SPL output ratio. Your audience will enjoy an engaging immersive musical experience.

### MULTIPURPOSE SOUND

Elegant design aesthetic, multiple formats and RCF signature sound quality that allows to deliver a supreme audio experience in any application, from restaurant and retail shops to clubs, corporate spaces and venues.



#### S 8028 II

- 141 dB SPL Max
- 3000 W RMS Power
- 12000 W Peak Power
- 30 ÷ 200 Hz Freq. Range
- 2 x 18" Woofer



#### S 8018 II

- 137 dB SPL Max
- 1500 W RMS Power
- 6000 W Peak Power
- 30 ÷ 200 Hz Freq. Range
- 18" Neo Woofer



#### S 8015 II

- 133 dB SPL Max
- 1500 W RMS Power
- 6000 W Peak Power
- 35 ÷ 200 Hz Freq. Range
- 15" Neo Woofer



#### S 8015LP

- 135 dB SPL Max
- 800 W RMS Power
- 3200 W Peak Power
- 43 ÷ 250 Hz Freq. Range
- 15" Woofer



#### S 12

- 125 dB SPL Max
- 400 W RMS Power
- 1600 W Peak Power
- 40 ÷ 200 Hz Freq. Range
- 12" Woofer



#### S 10

- 124 dB SPL Max
- 400 W RMS Power
- 1600 W Peak Power
- 45 ÷ 200 Hz Freq. Range
- 10" Woofer

# MONITOR SERIES

## TWO-WAY PASSIVE SPEAKERS

Bass-reflex two-way speaker designed to deliver uncompromised audio performance and high reliability in fixed installations.

Housed in self-extinguishing plastic, the MR series is designed to deliver uncompromising audio performance and reliability in fixed installations. MR speakers blend in with any environment and deliver deep bass, smooth

midrange, and finely-detailed high-frequency response. Quality components and careful acoustic design make the MR series a perfect choice for applications such as speech and music reproduction

### UNCOMPROMISED PERFORMANCE

Quality components and careful acoustic design make the MR series a perfect choice for applications such as speech and music reproduction in all A/V applications. Designed for easy installation into bars and restaurants, leisure hospitality, recreational facilities, theme parks,

shopping malls or audio monitoring facilities. All models use purpose-designed 1" voice coil woofers and 0.8" voice coil dome tweeters, combined with RCF Low Inductance Compensated Crossover (LICC) to assure exceptional audio performance and long-term reliability.



#### MR 50

- 110 dB SPL Max
- 60 W RMS Power
- 240 W Peak S Power
- 60 ÷ 20000 Hz Freq. Range
- 3000 Crossover Freq.
- 110° x 100° coverage angle
- 1" Neo Dome Tweeter
- 5" Woofer



#### MR 40

- 108 dB SPL Max
- 40 W RMS Power
- 160 W Peak S Power
- 70 ÷ 20000 Hz Freq. Range
- 3000 Crossover Freq.
- 110° x 100° coverage angle
- 1" Neo Dome Tweeter
- 4" Woofer





## VERSATILE SOUND

Elegant and discreet design, combined with an excellent audio performance, represent the RCF sound. MR speakers are ideal both for speech and music reproduction in any business and A/V application and deliver deep bass, smooth midrange, and finely-detailed high-frequency response.

## SMOOTH INSTALLATION

Housed in self-extinguishing plastic, the MR series delivers uncompromising audio performance and reliability in fixed installations where the speakers would blend into any environment. MR speakers are easy to install, with included and optional accessories to increase installation flexibility for wall mounting.

## CONSTANT VOLTAGE SPEAKERS (T VERSION)

Constant-voltage speaker systems, also called high impedance or 70V/100V audio distribution systems, refer to networks of loudspeakers equipped with line transformers connected to an audio amplifier with high impedance output. This approach offers several advantages such as:

- High voltage (70V or 100V) enables long cable runs between amp and speakers with reduced power loss: low level current allows smaller cable diameters

- Speakers can be wired in parallel in large number, limited only by available amplifier power
- Different speaker types with different power requirements can share the same speaker line simultaneously making the system-wiring easier
- Adding or removing a speaker is very quick and simple, it does not require to re-wire the overall circuit



### MR 50T

- 110 dB SPL Max
- 60 W RMS Power
- 240 W Peak S Power
- 60 ÷ 20000 Hz Freq. Range
- 3000 Crossover Freq.
- 110° x 100° coverage angle
- 1" Neo Dome Tweeter
- 5" Woofer



### MR 40T

- 108 dB SPL Max
- 40 W RMS Power
- 160 W Peak S Power
- 70 ÷ 20000 Hz Freq. Range
- 3000 Crossover Freq.
- 110° x 100° coverage angle
- 1" Neo Dome Tweeter
- 4" Woofer

# PROFESSIONAL AMPLIFIERS

## SOLUTIONS FOR ALL PASSIVE SPEAKERS

RCF offers an entire line of professional high-current and extended dynamic power amplifiers, suitable for stadia and sports arena installations.

RCF offers an entire line of professional high-current and extended dynamic power amplifiers, suitable for any installation and compatible with all RCF Stadia passive loudspeakers. High reliability, fast response, low distortion,

and operating safety are guaranteed by the use of the latest power amplification technologies for D, H, W and AB class amplifiers.

### QPS 9600

- 4 X 2400 High Power Pro Amplifier
- Fast response and low distortion
- Easy to configure in stereo / mono / bridge modes
- XLR input connectors
- SPEAKON NL4 output connectors
- Voltage clip switchable limiters
- Minimum load impedance (stereo / mono): 2 Ohm
- Extensive protective circuits ensure high reliability and operating safety
- Front panel signal / clippings / protection/ temperature LEDs indicators



### IPS SERIES

- 2 unit 19" rack, easy transportation
- 2 X 1500W Power Pro Amplifier Classe H (IPS 3700)
- 2 X 1100W Power Pro Amplifier Classe H (IPS 2700)
- 2 X 450W Power Pro Amplifier Classe H (IPS 1700)
- 2 X 300W Power Pro Amplifier Classe H (IPS 700)
- Fast response and low distortion
- Easy to configure in stereo / mono / bridge modes
- Front panel signal / clip / protect LED indicators
- XLR input connectors
- Extensive protective circuits ensure high reliability and operating safety
- SPEAKON NL4 output connectors







## DMA SERIES

- Class-D power amplifier
- 2 X 80W Two Channel Matrix Amplifier (DMA 82)
- 2 X 160W Two Channel Matrix Amplifier (DMA 162)
- 2 X 160W Two Channel Power Amplifier (DMA 162P)
- 20 ÷ 20000 Hz frequency range
- Full on-board processing
- RCF speakers presets
- FIRPHASE linear phase filters
- Proprietary bass enhancer algorithm
- RDNet ready
- Suitable for desktop or rack installation (optional accessory required)
- Flexible and scalable multi-room architecture
- MUTE command for the connection to Voice Alarm Systems



## DPS 604X

- 4 Channels Class D Power Amplifier With Crossover
- Fast response and low distortion
- Eight different operation modes, two of which with internal crossover
- Extensive protective circuits ensure high reliability and operating safety
- Level control for each channel on the front panel
- Signal and peak LED for each channel
- Suitable for rack installation (1U 19")



# ELECTRONICS

## ELECTRONIC DEVICES FOR ANY LIVE SOUND OR INSTALL USE

A complete range of powerful, robust, musical, and clean electronic devices for any live sound or install use. All electronics (DSPs, Matrix, etc...) follows all RCF quality requirements in terms of sound quality and reliability, stand-alone or on RDNet network.

### DX 4008

- 4 input - 8 output digital loudspeaker management system designed for the touring or fixed sound installation markets
- Sampling rate can be set to 96kHz
- Precise frequency control is achieved with its 1 Hz resolution
- Inputs and outputs can be routed in multiple configuration to meet any requirements
- The DX 4008 is shipped with a special PC Graphic User Interface (GUI) application - XLink
- XLink gives the user an option to control the DX 4008 unit from a remote PC via the RS232 serial communication link



- The GUI application makes much easier control and monitor the device, allowing the user to get the whole picture on one screen
- Programs can be recalled and stored from/to PC's hard drive, thus expanding the storage to become virtually limitless



### MZX 8060

- MATRIX AUDIO
- 40-bit floating point processing DSP and 48 kHz 24-bit HI-Q Analogue/Digital Conversion, dynamic range > 112 dB.
- 8 universal inputs (48V), 6 outputs - 4 Euroblocks bal., 2 RCA plugs
- 10 programmable logic inputs (GPI), 6 programmable logic outputs (GPO), 2 of which supported by relay.
- Configurable parametric EQs, gates, compressors, limiters, delays, priority levels, automatic gain control, levels, gains on in-out and cross points, auto-mixer operations, filters
- Each unit can work as dual-room combiner with independent auto-mixer facility for each room
- Configurable ALC (Automatic Level Control) facility by using Input 8 to connect a noise detection microphone. The control is then assignable to any output or group of outputs
- USB connectivity for device configuration
- RDNet Networked Control



### DX 1616

- MATRIX AUDIO PROCESSOR
- Hybrid architecture DSP
- 48 KHz sampling, 40 bit floating point engine
- 16 x 16 I/O matrix
- Dante enabled network audio transport
- 8 AES/EBU inputs - 8 AES/EBU outputs
- Ethernet connectivity and control
- Maximum latency 3 ms
- Easy to use software GUI





## MS 1033

- CD / MP3 PLAYER, FM TUNER
- Double sound source with two independent sections and outputs (Tuner - CD/MP3)
- CD player insert to reproduce audio tracks and MP3 files from a compact disc (CD, CD-R, CD-R/W)
- MP3 player from the USB drive or SD-Card drive ("Flash" memory-stick)
- The USB port is available on both the front and back panels to provide maximum flexibility
- LCD display gives information on the CD and MP3 files



- I/R remote control included
- FM radio tuner (87.5 - 108 MHz) with possibility to memorize your 30 favourite radio stations
- LCD display shows the frequency and stations that are in the memory



## RDNET CONTROL 8

- 8 OUTPUT MASTER UNIT
- Ethernet (remote control) and USB (direct control) PC connection to RDNet
- Control up to 8 SUB-NETS of up to 32 slave devices
- All devices are cyclically scanned ("polling") 10 times a second
- Auto detect device placement
- Controlling slave devices status and functions
- Monitoring and displaying faults and warnings sent from slave devices
- Storing subnet user filters configuration in a removable memory card



## RDNET CONTROL 2

- 2 OUTPUT MASTER UNIT
- Real-time USB device monitoring and control
- Auto detect device placement
- Control up to 2 SUB-NETS of up to 32 slave devices
- All devices are cyclically scanned ("polling") 10 times a second
- Connected devices are automatically added to the software synoptic

# PART NUMBERS

## COLUMN SPEAKERS

PRODUCT	Colour	220-240V	115V	-
VSA 2050 II	White	13100022	13100023	-
VSA 2050 II B	Black	13100053	13100054	-
VSA 2050 II	Custom	13100024	13100031	-
VSA 1250 II	White	13100025	13100026	-
VSA 1250 II B	Black	13100055	13100056	-
VSA 1250 II	Custom	13100027	13100032	-
VSA 850 II	White	13100028	13100029	-
VSA 850 II B	Black	13100057	13100058	-
VSA 850 II	Custom	13100030	13100033	-
L 2406T W	White	-	-	13000177
L 2406T	Black	-	-	13000169

## COMPACT SERIES

PRODUCT	Colour	-	-	-
C 5215-99	Black	13000313	-	-
C 5215-96	Black	13000311	-	-
C 5215-94	Black	13000309	-	-
C 5215-66	Black	13000312	-	-
C 5215-64	Black	13000310	-	-
C 5212-99	Black	13000308	-	-
C 5212-96	Black	13000306	-	-
C 5212-94	Black	13000304	-	-
C 5212-66	Black	13000307	-	-
C 5212-64	Black	13000305	-	-

## COMPACT M SERIES

PRODUCT	Colour	-	-	-
COMPACT M 12	Black	13000596	-	-
COMPACT M 12 W	White	13000724	-	-
COMPACT M 10	Black	13000595	-	-
COMPACT M 10 W	White	13000723	-	-

## COMPACT M SERIES

PRODUCT	Colour	-	-	-
COMPACT M 08	Black	13000594	-	-
COMPACT M 08 W	White	13000722	-	-
COMPACT M 06	Black	13000582	-	-
COMPACT M 06 W	White	13000721	-	-
COMPACT M 05	Black	13000581	-	-
COMPACT M 05 W	White	13000720	-	-
COMPACT M 04	Black	13000623	-	-
COMPACT M 04 W	White	13000725	-	-

## MAX SERIES

PRODUCT	Colour	-	-	-
V 45	Black	13000413	-	-
V 218-S	Black	13000414	-	-
X MAX 12	Black	13000658	-	-
X MAX 10	Black	13000657	-	-
C MAX 4112	Black	13000535	-	-
C MAX 4110	Black	13000534	-	-
E MAX 3112	Black	13000578	-	-
E MAX 3110	Black	13000577	-	-

## P SERIES

PRODUCT	Colour	-	-	-
P 6215	Black	13000131	-	-
P 6215 W	White	13100083	-	-
P 3115T	Black	13000135	-	-
P 3115T W	White	13100082	-	-
P 2110T	Black	13000125	-	-
P 8015S	Black	13000230	-	-
P 5228-L	Black	13000202	-	-
P 4228	Black	13000199	-	-
P 4228 W	White	13100081	-	-



## P SERIES

PRODUCT	Colour	-	-	-
P 3108	Black	13000198	-	-
P 1108T	Black	13000203	-	-
P 1108T W	White	13100084	-	-

## ART 3 SERIES

PRODUCT	Colour	-	-	-
ART 725 MK4	Black	13000548	-	-
ART 315 MK4	Black	13000587	-	-
ART 312 MK4	Black	13000586	-	-
ART 310 MK4	Black	13000585	-	-

## SUB SERIES

PRODUCT	Colour	-	-	-
S 8028 II	Black	13000391	-	-
S 8018 II	Black	13000390	-	-
S 8015 II	Black	13000398	-	-
S 8015LP	Black	13000168	-	-
S 12	Black	13000618	-	-
S 10	Black	13000617	-	-

## MONITOR SERIES

PRODUCT	Colour	-	-	-
MR 50	Black	13100038	-	-
MR 50 W	White	13100040	-	-
MR 50T	Black	13100039	-	-
MR 50T W	White	13100041	-	-
MR 40	Black	13100034	-	-
MR 40 W	White	13100036	-	-
MR 40T	Black	13100035	-	-
MR 40T W	White	13100037	-	-

## AMPLIFIERS

PRODUCT	Colour	220-240V	230V	115V
QPS 9600	Black	-	12135102	12135103
IPS 3700	Black	-	12135093	12135092
IPS 2700	Black	-	12135091	12135090
IPS 1700	Black	-	12135089	12135088
IPS 700	Black	-	12135087	12135086
DPS 604X	Black	12100008	-	12100012

## AMPLIFIERS DMA SERIES

PRODUCT	Colour	EU	US	UK
DMA 82	Black	12100026	12100040	12100043
DMA 162	Black	12100027	12100041	12100044
DMA 162P	Black	12100028	12100042	12100045

## ELECTRONICS

PRODUCT	Colour	-	90-240V	-
DX 4008	Black	12135033	-	-
DX 1616	Black	12399033	-	-
MZ 8060	Black	17100004	-	-
M5 1033	Black	-	17170108	-
RDNET CONTROL 8	Black	17170154	-	-
RDNET CONTROL 2	Black	17170163	-	-



www.rcf.it

HEADQUARTERS:

RCF S.p.A. Italy  
tel. +39 0522 274 411  
e-mail: info@rcf.it

RCF UK  
Int. +44 (0) 1702 800846  
e-mail: info@rcfaudio.co.uk

RCF France  
tel. +33 6 24 15 81 76  
e-mail: france@rcf.it

RCF Germany  
tel. +49 2203 925370  
e-mail: germany@rcf.it

RCF Spain  
tel. +34 91 817 42 66  
e-mail: info@rcfaudio.es

RCF Benelux  
tel. +49 (0) 2203 9253724  
e-mail: benelux@rcf.it

RCF USA Inc.  
tel. +1 732-9026100  
e-mail: info@rcf-usa.com

Note to specifications: audio power data refers to peak power

The data and designs are not binding; RCF reserves the right to modify the data and designs at any time and without previous notice.